

Order Invoice



Invoice #100058

Date : 03-03-2024 10:07:29 pm

Shop Name : svr engineers

Shipping to

dhiraj heavy equipments Pvt ltd
info@dhirajequipments.com
+918605004005
survey no 25/8, narhe industrial area, dhayari road,
narhe, Pune 411041, maharashtra, india
pune 411041

Billing address

dhiraj heavy equipments Pvt ltd
+918605004005
survey no 25/8, narhe industrial area,
dhayari road, narhe, Pune 411041,
maharashtra, india
pune 411041

SL	Item description	Unit price	Qty	Total
1	DESIGN AND ENGINEERING	90,000.00₹	1	90,000.00₹
			Sub total	90,000.00₹
			Tax	16,200.00₹
			Shipping	0.00₹
			Coupon discount	- 0.00₹
			Discount on product	- 0.00₹
			Total	106,200.00₹

Payment details
unpaid , 24-03-03

If you require any assistance or have feedback or suggestions about our site you
Can email us at info@energypowerworld.co.uk

Phone : +919315775092
Email : info@energypowerworld.co.uk
<https://business.energypowerworld.co.uk>
All copy right reserved © 2024 EnergyPowerBusiness

Product Details

Reviews



DESIGN AND ENGINEERING

Approved

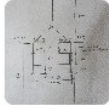

Product Specification

Purchase Price	₹90,000.00
Selling Price	₹90,000.00
Tax	18.0%
TaxModel	Exclude
Discount	₹0.00
Current Stock	9
Category	design and engineering
Product Type	Physical
Shipping Cost	₹0.00

Description

1. All Structure should in nut bolting 2. All Structure members pipes and folded sections to be used 3. Bottom of all platforms chequered plates to be used 4. Outside Diameter and Inside diameter of platforms with safety railings. 5. About 1 Ton load on each platform (Tota B Ton Load on B platforms 6. Person and machinery loading on platforms will be at well top after inserting platforms. 7. Opening for entry of persons and machinery in platforms at 4 places @90 Deg. in each platform. 8. To avoid jerks jacking system to be used at well ID and platfroms OD. 9. All individual structure members should @2mtr x 2mtr for easy transportation to we top from bottom 101 Individual weight of structure members should not exceed above 30 kgs. Approx

Shipping Type (Product Wise)

Choose Delivery Type



Customer information



dhiraj heavy equipments Pvt Ltd

2 Orders

+918605004005

info@dhirajequipments.com

Shipping address

Name : **dhiraj heavy equipments Pvt Ltd**

Contact: **+918605004005**

City: **pune**

Zip code : **411041**

 pune

Billing address

Name : **dhiraj heavy equipments Pvt Ltd**

Contact: **+918605004005**

City: **pune**

Zip code : **411041**

 pune



Order Details

Order ID #100059

Show locations on map

Print Invoice

03 Mar 2024 22:21:17

Status: Pending

Linked orders (0) :

Payment Method : Cash On Delivery

Payment Status: Unpaid

SL	Item Details	Variations	Tax
1	 DESIGN AND ENGINEERING... Price : 90,000.00₹ Qty : 1		16,200.00₹
Shipping			0.00₹
Coupon discount			- 0.00₹
Total			106,200.00₹

Order & Shipping Info

Order Status

Pending



Payment Status

Unpaid



Shop Information



svr engineers

0 Orders Served

8329411479

 11/137 lokmanya Nagari back gate of sp college lal bahadur shastri road Pune 411030 maharashtra India

© EnergyPowerBusiness. CopyRight EnergyPowerBusiness@2023

 Business Setup

 Profile

 Home

Software Version 13.1

SWINGING RACK

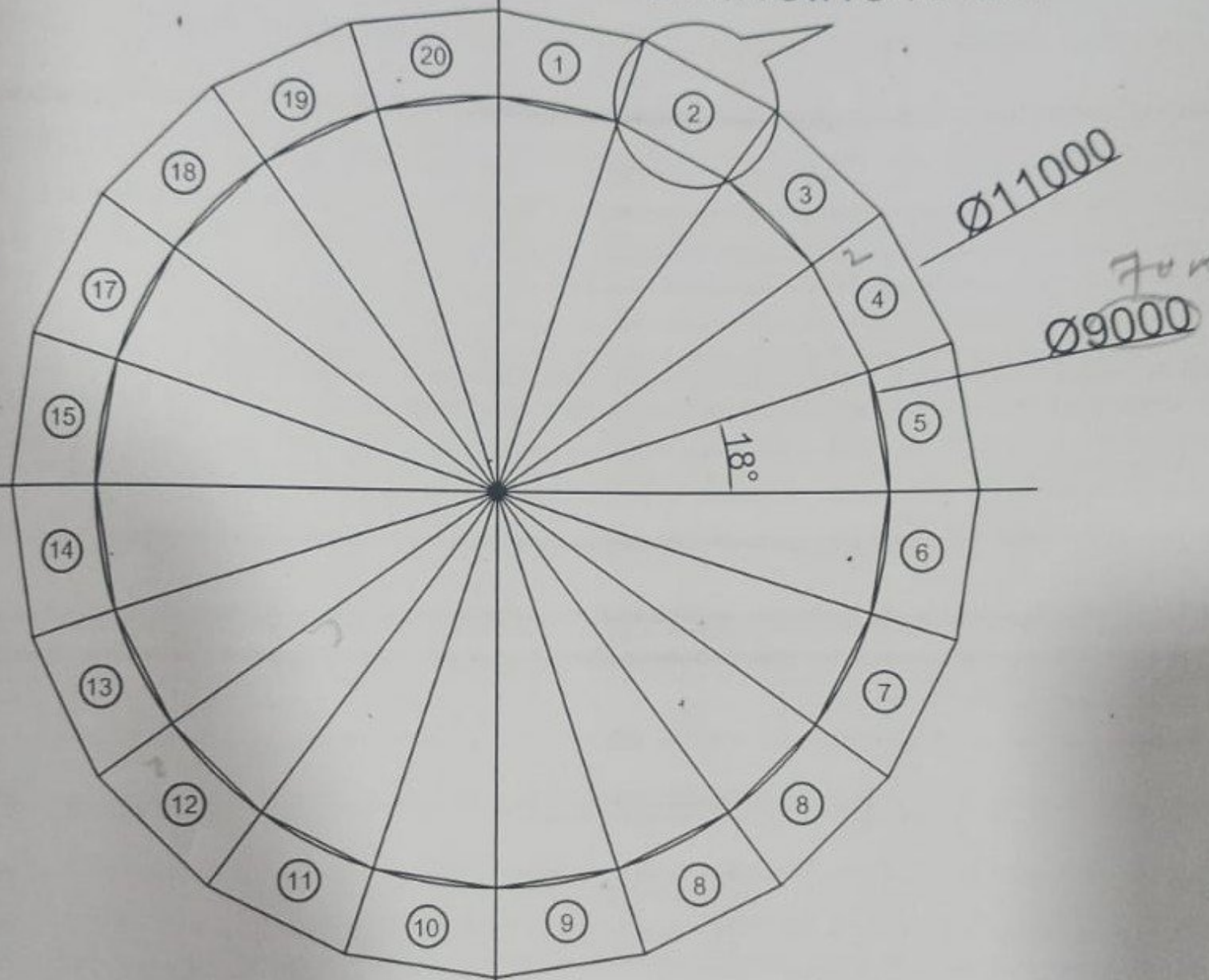

SWINGING RACK ASSEMBLY